

NOTE: ALL HARDWARE STAINLESS STEEL

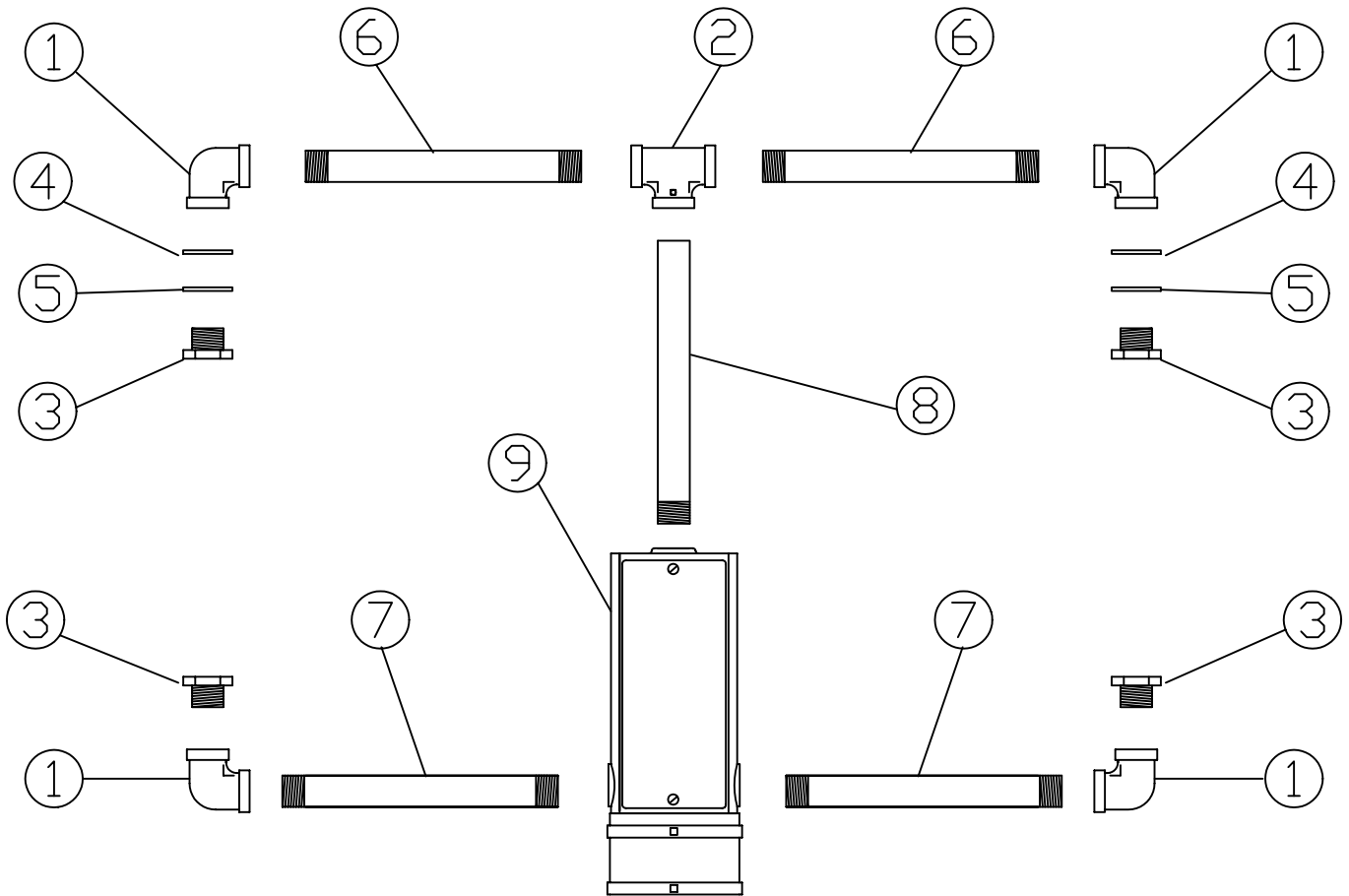

WTS803041BG

2-WAY T.O.P. PED WEST COAST GREEN

REF. NO.	DESCRIPTION	QTY.	PART NO.	WA. TYPE "C"
1	ELBOW SERRATED	4	DTSH0174F	
2	TEE REAMED	1	DTSH0202F	
	SET SCREW SQ. HD. 1/4-20X1/2	1	CMH25C50SSQS	
3	LOCK NIPPLE (LONG)	4	DTSH0571F	
4	WASHER NEOPRENE	2	DTSH0531	
5	WASHER STEEL	2	DTSH0533	
6	NIPPLE 12 1/2"	2	DWTS12.5N	
7	NIPPLE 12"	2	DWTS12.0N	
8	CENTER PIPE 8 1/4"	1	DWTS8.25C	
9	POST TOP TERMINAL COMPARTMENT	1	DTSH0031B	
	TERMINAL COMPARTMENT DOOR	1	DTSH1101	
	TERMINAL COMPARTMENT DOOR GASKET	1	DTSH2028	
	12 POSITION TERMINAL BLOCK	1	DTSH0567	
	SCREW 10-32X1 1/4"	2	CMH10F125MPPS	
	SCREW 10-32X1/2"	2	CMH10F50MPPS	
	SET SCREW SQ. HD. 3/8-16X3/4"	6	CMH37C75SSQS	



**WESTERN
SYSTEMS**

909 SE EVERETT MALL WAY #A120
EVERETT, WA 98208
PHONE (425)438-1133
FAX (425)438-1585